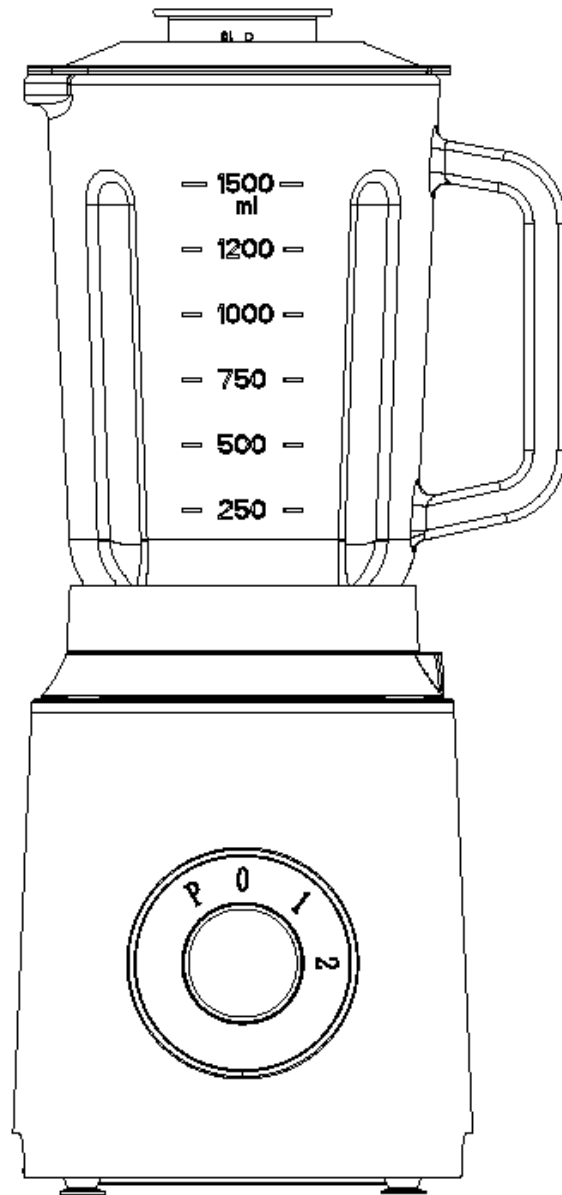

TABLE BLENDER INSTRUCTION MANUAL

Well®



Aroma

(220~240V, 50/60Hz, Rated power 600W, Mixing cup capacity: 1500ml)

Product structure diagram

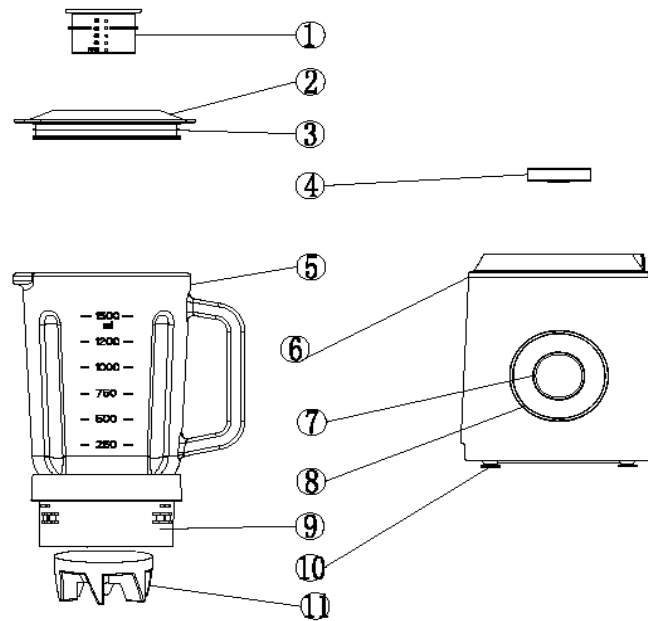

- | | | |
|---------------------|-----------------|------------------|
| 1. Center small cup | 5. Glass cup | 9. Cup holder |
| 2. Mixing cup lid | 6. body | 10. Rubber feet |
| 3. Cup lid seal | 7. Switch knob | 11. Upper clutch |
| 4. Motor clutch | 8. switch panel | |

IMPORTANT SAFETY INSTRUCTION

When using electrical appliances, to reduce the risk of fire, electric shock, and/or injury to persons, basic safety precautions should always be followed, including the following:

You should respect the following safety warnings:

⚠ WARNING: the blades of the knife are extremely sharp. Handle them with caution.

1. Read all instructions carefully.
2. To protect against electric shock, do not place cord, plug or appliance in water or other liquid.
3. Close supervision is necessary when any appliance is used by or near children.
4. This appliance is not intended for use by persons (including children) with reduced physical, sensory or mental capabilities, or lack of experience and knowledge, unless instructions concerning use of the appliance by a person responsible for their safety.
5. Unplug from outlet when not in use and before cleaning.
6. Do not operate any appliance with a damaged cord or plug, in case of appliance malfunctions or if the appliance has been damaged in any manner.
7. The use of accessory attachments not recommended by manufacturer may cause malfunctions.
8. Do not use outdoors.
9. Do not let cord hang over edge of table or counter, or touch hot surfaces.
10. Do not place the appliance on or near hot gas or electric burner, or in a heated oven.
11. This product has been designed for domestic use only. Any commercial use, inappropriate use or failure to comply with the instructions, the manufacturer accepts no responsibility and guarantee is no more valid.
12. Do not use your food processor if any part is broken.
13. Do not put the appliance, the power cord or the plug into water or any other liquid.
14. Make sure that the cover is securely locked in place before operating the appliance.
15. Never place ingredients in the container by hand and while the appliance is in use. Always use the food

pusher.

16. The blade and discs are sharp. Handle carefully. Store out of reach of children.
17. If the power cord or the plug are damaged, do not use your appliance.
18. For your own safety, please use only the original accessories and spare parts which are suitable for your appliance.
19. Never remove the lid until the knife has stopped completely.
20. This appliance is designed to process small quantities. Do not exceed the quantities indicated in these instructions for use.
21. Do not use this appliance to mix glutinous food or substance.
22. Do not use appliance for other than intended use.
23. For your safety, this appliance conforms to the appliance standards, regulations and directives of Low Voltage, Electromagnetic Compatibility, Environment, etc.

How to use the mixing cup

1. 1. Place the main unit on a flat, dry workbench, make sure that the switch knob is set to "0" before turning on the power (see Figure 1), and plug in a power source that meets the requirements on the main unit's nameplate.
2. 2. Wash the mixing cup to ensure that there are no other debris in the mixing cup. Cut the vegetables or fruits to be processed into small pieces, put them into the cup (see Figure 2), add an appropriate amount of water, and then cover the cup lid and cup. Cap (see Figure 3/4). Note that the amount of water added must not exceed the maximum capacity of the beaker. (Food is $\frac{2}{5}$ of the cup capacity and water is $\frac{3}{5}$)
3. 3. After inserting the drive connector of the lower end of the mixing cup vertically aligned with the output shaft of the motor base, hold the handle of the cup to rotate the cup clockwise, and snap the cup into the lock on the main unit to confirm the installation. When the stirring cup holder presses the safety ejector lever on the host, the safety switch in the host is touched (see Figure 5).
4. 4. When processing, first turn the knob counterclockwise to "P" for several times, and then turn the knob to the corresponding "Gear" to process. Position, if higher speed is needed, turn the switch knob to the "2nd gear" position. Figure 6
5. Depending on the volume and variety of processed foods, users can choose 2 gears from low to high, that is, low gear with small capacity and easy processing; otherwise, high gear.
6. If you want to see the stirring effect halfway, you can rotate to open the small transparent cover, or you can add fruits, vegetables or water from the small halfway.
7. After use, turn the switch knob to "0 stop" (as shown in Figure

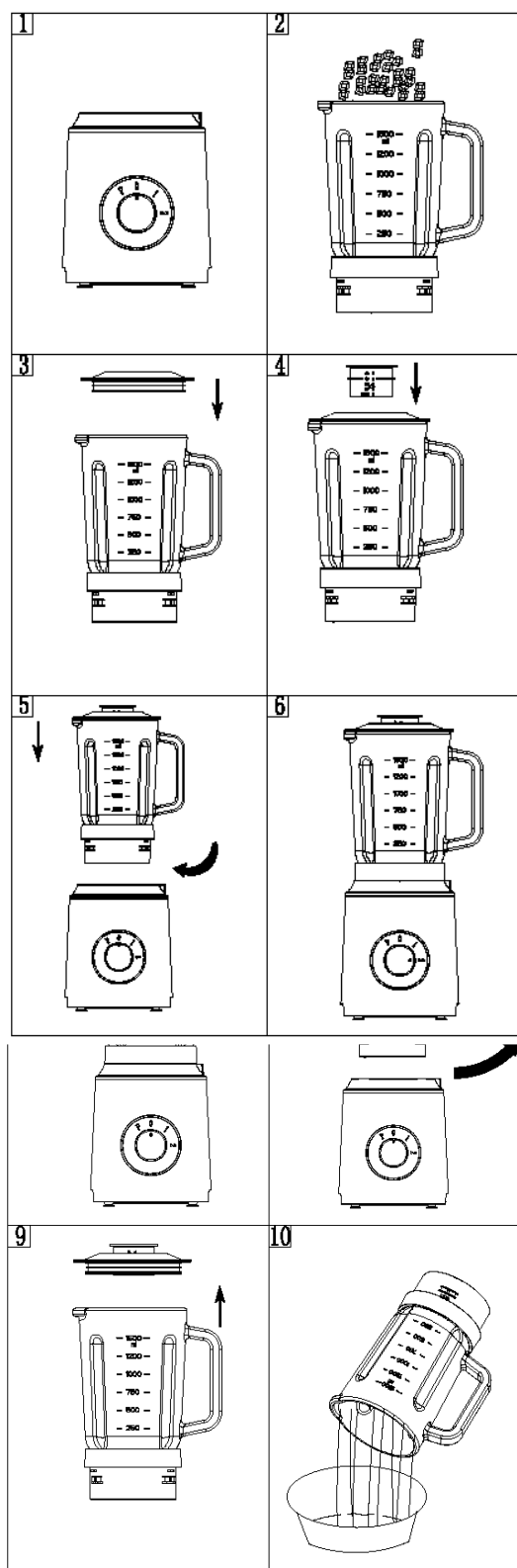

7), unplug the power cord to stop the machine, turn the mixing cup counterclockwise by about 30 degrees, and then remove the cup (see figure 8) Pour the contents of the cup into the prepared utensil. (Figure 9/10)

8. Do not spray water or other liquids during use.

◆ □ **Cleaning method**

1. Add the right amount of warm water and a small amount of food detergent when cleaning the mixing cup, cover the cup cover and turn the switch knob "P" to run for about 10 seconds (see Figure 11); you can also immerse the mixing cup in water Brush cleaning.

□ 2. After stirring, turn the switch knob to the "0" position, unplug the power cord and remove the mixing cup from the host (see Figure 12), then remove the cup cover assembly and pour out the water. Use a dry cloth or towel Dry the blender. (Note: the mixing knife in the cup is very sharp, be careful to hurt your hands)

3. The main body should be wiped clean with a damp cloth. Do not rinse with water to avoid damaging the machine..

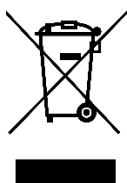
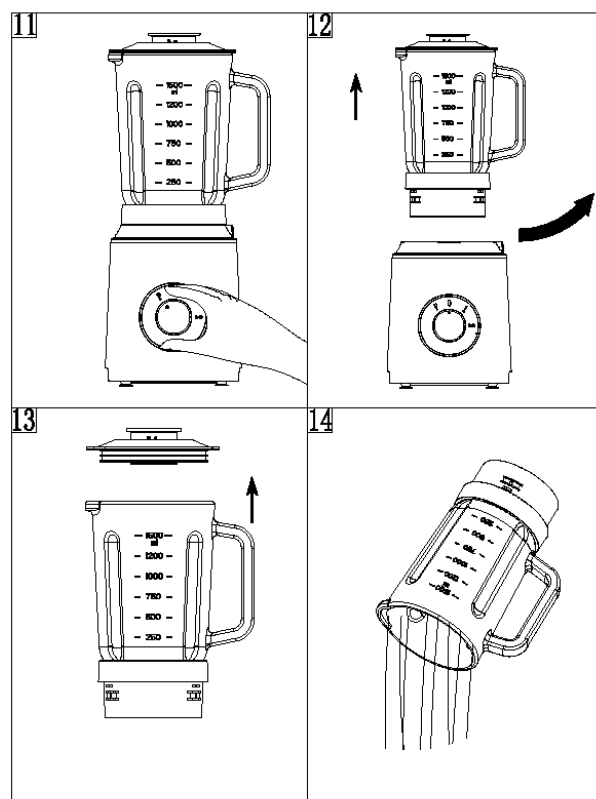

Waste electrical and electronic equipment are a special waste category, collection, storage, transport, treatment and recycling are important because they can avoid environmental pollution and are harmful to health. Submitting waste electrical and electronic equipment to special collection centers makes the waste to be recycled properly and protecting the environment. Do not forget! Each electric appliance that arrives at the landfill, the field, pollutes the environment!



Importer & distributor:

SC VITACOM ELECTRONICS SRL

CIF: RO 214527

Tel. 0264-438401*

sales@vitacom.ro, www.vitacom.ro